

## Phase 1

Road to be closed from location (A) - (B).

Specials signage allocated to this phase.

## Phase 2

Road to be closed from location (B) - (E)

special signage allocated to this phase

(Specials to be placed opposite end of closure)

Special's for site A - B

**Station Road  
CLOSED AHEAD  
After Beechings Close  
From  
22/07/2021 - 29/09/2021  
No Through Route  
To B1166 Leverington Common  
Follow Diversion**

X 2

**Garden Lane  
CLOSED AHEAD  
No Through Route  
Follow Diversion**

X 2

Special's for site B - E

**Station Road  
CLOSED AHEAD  
No Through Route  
Find Alternative**

X 1

**Station Road  
CLOSED AHEAD  
After Beechings Close  
From  
22/07/2021 - 29/09/2021  
No Through Route  
To High Road  
Follow Diversion**

X 1

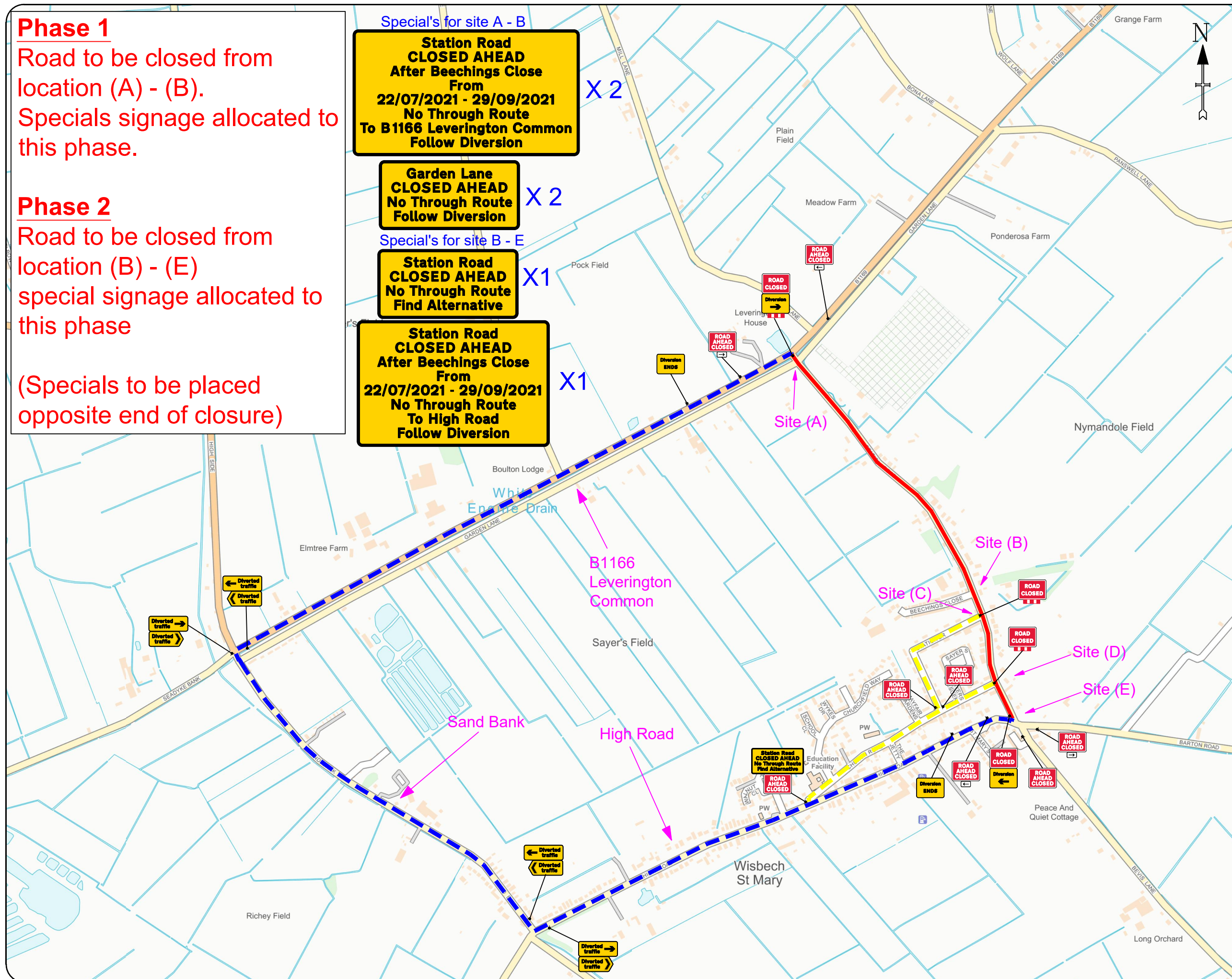

### Notes:

- A - Do not scale from this drawing
- B - All temporary traffic management shall be in accordance with Chapter 8 of the Traffic Signs Manual 2009
- C - All temporary traffic management shall be in accordance with the Traffic Signs Regulations and General Directions 2014
- D - All temporary traffic management shall conform to the Safety at Street Works and Road Works Code of Practice 2013
- E - All temporary traffic management sign locations are indicative and are subject to onsite approval from engineer

### KEY

- Sign
- Traffic Cone
- Road Closure
- Access Only
- Diversion Route

### DIVERSION ROUTE:

LEVERINGTON COMMON, GOREFIELD > SANDBANK, WISBECH ST MARY > HIGH ROAD, WISBECH ST MARY & VICE VERSA

### Site location (A) - (E)

For Grids -  
541762-309148 (A)  
542243-308521 (B)  
542265-308461 (C)  
542306-308461 (D)  
542306-308277 (E)

REV:	Revised Location	-	-
REV:	Initial Issue	LL	22/12/20
REV:	DESCRIPTION:	BY:	DATE:

STATUS: FOR APPROVAL

**tbf** Traffic  
The Lion Barn  
Maitland Road  
Needham Market  
Suffolk  
01449 490865

CLIENT:  
**love every drop**  
anglianwater

SITE: Station Road/Leverington Com  
Gorefield PE13 5JJ

TITLE: Road Closure  
and Diversion

SCALE AT A3:	DATE:	DRAWN:	CHECKED:
AS SHOWN	22/12/20	LL	AS
TRAFFIC SENSITIVE:	DRAWING NO:	REVISION:	
n/a	TBF20881	-	